



# SVM BAPLIE Viewer

USER MANUAL

## Table of Contents

Disclaimer .....	2
Introduction.....	3
SVM BAPLIE Viewer Log in .....	4
Resetting Password .....	5
Home Page .....	7
Loading a BAPLIE from the history list.....	7
Loading a new BAPLIE .....	8
Landing Page .....	9
Tabular mode .....	9
Export.....	11
2D view.....	12
3D View .....	15
Filter View .....	16
3D control panel .....	18
Toggle icon.....	18
360° rotation view .....	18
Hatch Covers.....	18
Wire Frames view.....	19
Reset View .....	19
Hull View .....	20

## Disclaimer

All rights reserved. This product and related documentation are protected by copyright and distributed under licensing, restricting their use, copying, distribution, and recompilation. No part of this documentation may be reproduced in any form or by any means without the prior written authorization of Solverminds Solution Technologies.

Copyright © 2022 Solverminds Solution Technologies Private Limited

## Introduction

Decoding and process BAPLIE files is a critical process for container operators and carriers. SVM BAPLIE Viewer is the essential tool to decode and visualize UNEDIFACT BAPLIE standard files.

SVM BAPLIE viewer helps the industry by enabling easy access to the information that otherwise requires cumbersome data translators and expensive analysis tools.

SVM BAPLIE viewer includes unique visualization tools and customizable reports to visualize the data like never before.

## SVM BAPLIE Viewer Log in

To access SVM BAPLIE Viewer open this link <https://svmbaplieviewer.solverminds.net/> in your browser (we recommend using chrome)

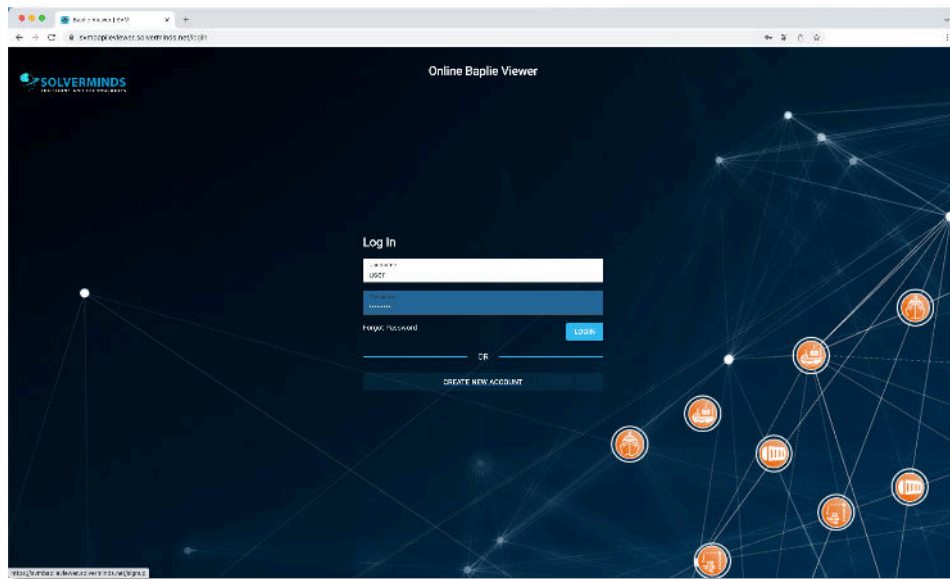

On the Login section, enter your username and password and click on *LOGIN*

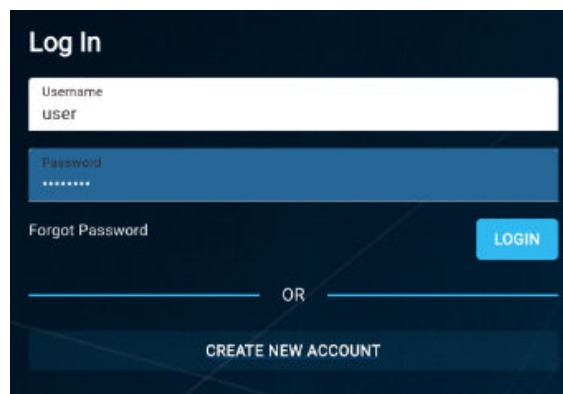

You can log out anytime by clicking on the LOGOUT button in the top-right corner

## Resetting Password

If you forget your password to access SVM BAPLIE Viewer, there is a way to reset it on the login screen. Follow the following steps to reset your password:

- Click on *Forgot Password* link



Forgot Password

- Enter your corporate email address and click on *SUBMIT*

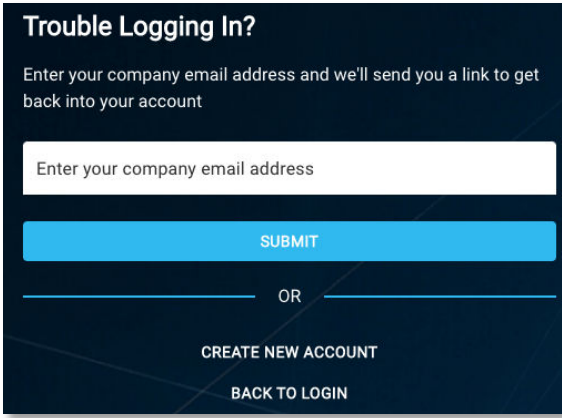

**Trouble Logging In?**

Enter your company email address and we'll send you a link to get back into your account

Enter your company email address

SUBMIT

OR

CREATE NEW ACCOUNT

BACK TO LOGIN

- An email is sent to you with resetting password instructions. You'll see a confirmation message



✔ Your reset password link has been successfully sent to your email. ✕

- Check your inbox for a message with instructions on how to reset your password

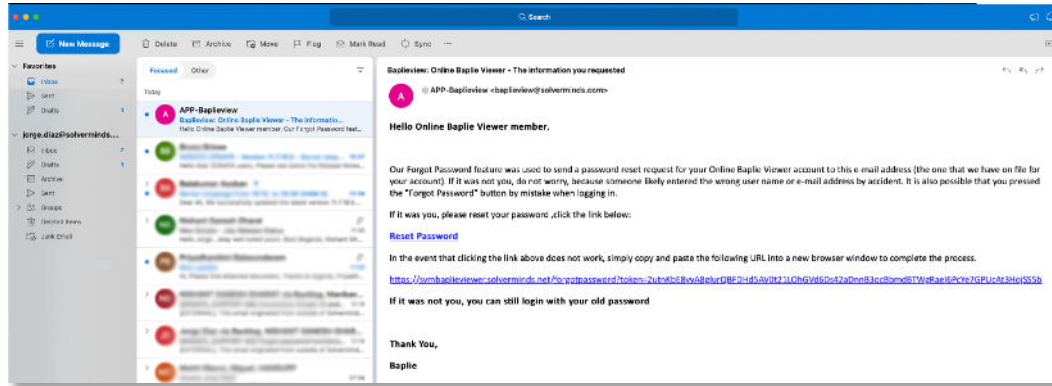

- Clicking on the reset password link in the email body will take you to the Reset Password screen. Enter your new password and click on **RESET PASSWORD** (we require using strong passwords that contain at least one uppercase, lowercase, number, and a special character)

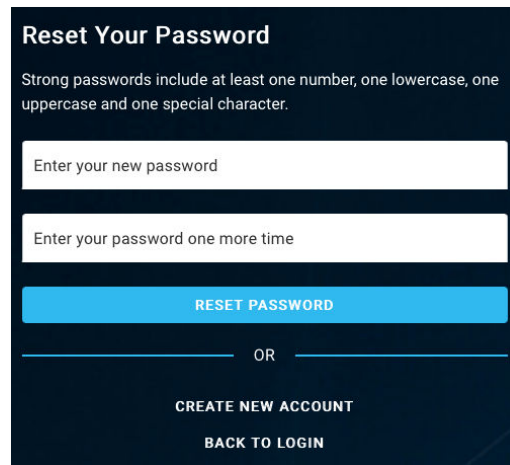
A dark-themed form titled 'Reset Your Password'. Below the title, it states: 'Strong passwords include at least one number, one lowercase, one uppercase and one special character.' There are two input fields: 'Enter your new password' and 'Enter your password one more time'. A prominent blue button labeled 'RESET PASSWORD' is centered below the fields. Below the button, the text 'OR' is centered, followed by three options: 'CREATE NEW ACCOUNT' and 'BACK TO LOGIN'.

- After resetting your password, you will be directed to the login page

## Home Page

After login, you are directed to the Home Page.

Here you can load a previously uploaded BAPLIE\* file or upload a new BAPLIE

Click on the Upload BAPLIE icon



### Loading a BAPLIE from the history list

A history of the previous BAPLIE files uploaded by you is stored in SVM BAPLIE Viewer and it's displayed on the LOAD BAPLIE screen. You can choose any of the BAPLIE from the list and click on it to load it.

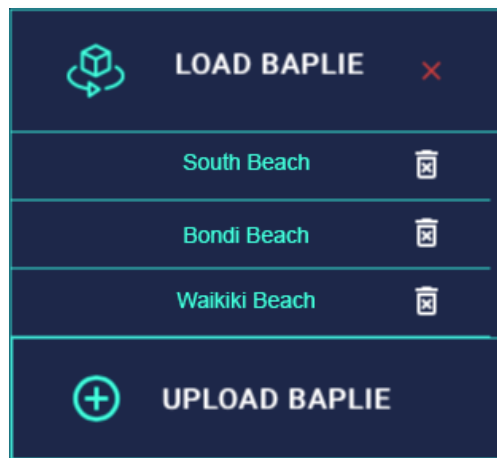

You can also remove any BAPLIE from the history list by clicking on the recycling bin. When you click on it, a confirmation message is displayed and requires the user's confirmation to proceed with the record deletion

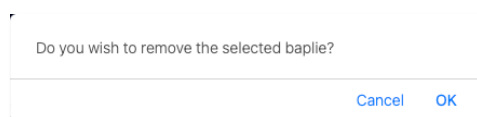



## Loading a new BAPLIE

You can upload a new BAPLIE anytime by clicking on the UPLOAD BAPLIE



The file browser is open. Pick the folder and select the BAPLIE file you want to upload and click on *upload*

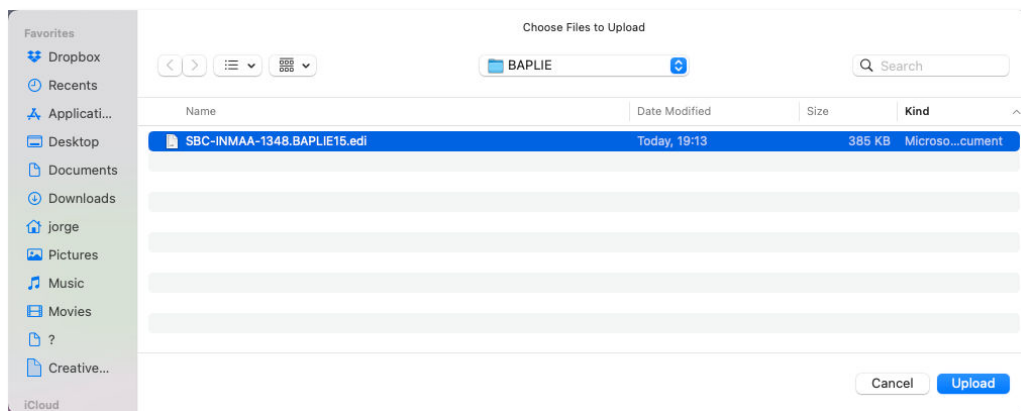

\* The free BAPLIE Viewer user is allowed to upload and store up to 3 BAPLIE, to load more, the previous BAPLIE files must be deleted. The data is stored in encrypted tables. Additionally, we use HTTPS (SSL/TLS) protocols.

## Landing Page

Once you have uploaded the BAPLIE file successfully you will be directed to the Landing Page.

Landing Page is where you will find all the information related to the loaded BALIE file. Here you can see the BAPLIE content as

### Tabular mode

This view displays the full content of the BAPLIE file. To enable this view, click on the table icon 



The screenshot shows a web application interface titled "SOUTH BEACH: Cargo Details". It features a table with columns for Cntr No, ISO, Weight, Is Vgm, POL, POD, Operator, F Dest, Is Empty, and Stowag. The table contains 15 rows of data, each with a checkbox in the Cntr No column. The interface also includes a top navigation bar with a "LOGOUT" button and an "Export" dropdown menu. The bottom of the interface shows pagination information: "1 to 15 of 4,098", "Page 1 of 274", and "15 Items per page".

Cntr No	ISO	Weight	Is Vgm	POL	POD	Operator	F Dest	Is Empty	Stowag
<input checked="" type="checkbox"/> PROJ002651	45G0	14.9	<input type="checkbox"/>	MYTPP	BRITJ	MSK		<input type="checkbox"/>	540981
<input checked="" type="checkbox"/> PROJ002914	22G0	21	<input type="checkbox"/>	CNYTN	BRITJ	CCN		<input type="checkbox"/>	310104
<input checked="" type="checkbox"/> PROJ006438	22G0	28	<input type="checkbox"/>	CNSHA	BRSSZ	CMA		<input type="checkbox"/>	571310
<input checked="" type="checkbox"/> PROJ008507	22G0	29.8	<input type="checkbox"/>	CNYTN	BRSSZ	CSC		<input type="checkbox"/>	631912
<input checked="" type="checkbox"/> PROJ008712	45G0	16	<input type="checkbox"/>	CNSHA	BRPNG	CMA		<input type="checkbox"/>	341110
<input checked="" type="checkbox"/> PROJ0011073	42G0	15	<input type="checkbox"/>	CNSHA	BRITJ	CSV		<input type="checkbox"/>	620212
<input checked="" type="checkbox"/> PROJ0011074	42G0	15	<input type="checkbox"/>	CNSHA	BRITJ	CSV		<input type="checkbox"/>	620112
<input checked="" type="checkbox"/> PROJ0011585	22G0	20.07	<input type="checkbox"/>	KRPUS	BRSSZ	CCN		<input type="checkbox"/>	171008
<input checked="" type="checkbox"/> PROJ0012064	45R0	4	<input type="checkbox"/>	CNSHA	BRSSZ	CMA		<input checked="" type="checkbox"/>	540809
<input checked="" type="checkbox"/> PROJ0012165	45G0	10	<input type="checkbox"/>	CNSHA	BRITJ	HJS		<input type="checkbox"/>	620319
<input checked="" type="checkbox"/> PROJ0012966	45G0	8.33	<input type="checkbox"/>	KRPUS	BRSSZ	HSD		<input type="checkbox"/>	420909
<input checked="" type="checkbox"/> PROJ0018280	45R0	8.4	<input type="checkbox"/>	HCHKG	BRITJ	MSK		<input type="checkbox"/>	260195

On the right side, there is an option to enable or disable columns from the table. It opens by clicking on the *Columns* section.

Drag the attribute to the row group to set the filter; drag the attribute to the *aggregate* section, to sum up the values.

Click on *Pivot* to enable and disable the Pivotal table mode

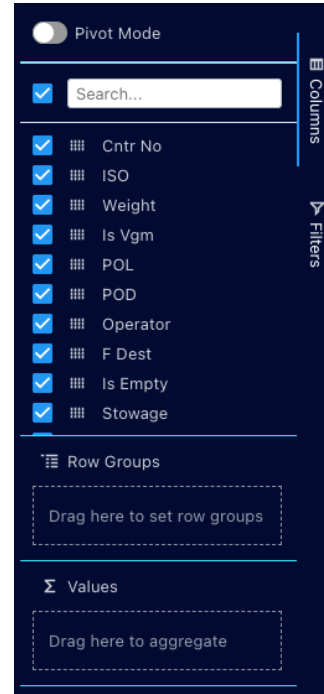

Also, there is a filter tool you can use to create a customized list (empty equipment list, DG list, Reefer list, etc.). You can use any attribute from the BAPLIE segments as a filter. Only attributes present in the BAPLIE loaded are displayed as filters

Click on any attribute and select the value you want to filter

- *Clear*: it clears any applied filter
- *Container type*: Filter by container type (General, Tank, Flat-rack, Open top, Platform, Reefer)
- *By Height*: Filter containers by height (8', 8'6", 9'6")
- *By ISO Code*: Filter available with different ISO codes.
- *By Hazardous*: Filter Hazardous cargo on board
- *By OOG*: Filtering OOGs on board
- *By REEFER*: Filter Live Reefers
- *By Length*: Filter the containers with 20', 40', 45'
- *By Line Operator*: Filter by container operators
- *By Port of Discharge*: Filter by port of discharge
- *By Port of Load*: Filter the boxes by Port of Load

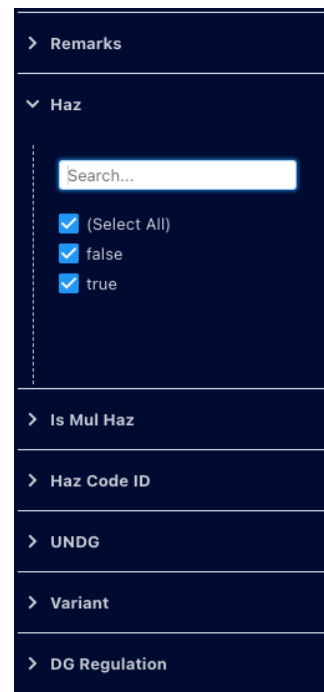

## Export

SVM BAPLIE Viewer includes a reporting tool to export any list, filter, or table for further analysis or reporting.

In [Tabular mode](#), click on the Export dropdown menu located in the upper-right corner



There are 2 different filters in the Export menu:

- Export (the complete content of the table will be exported)  
You can select the export format (csv or excel) by clicking on the Export dropdown menu

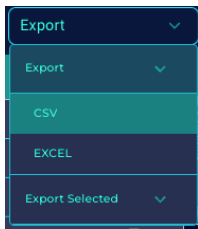

- Export selected (only selected rows will be exported)  
To select a row to export, click on the check mark on the left part of the table. You can select all or select individual rows

<input type="checkbox"/>	Cntr No
<input checked="" type="checkbox"/>	PROJ0002651
<input checked="" type="checkbox"/>	PROJ0002914
<input checked="" type="checkbox"/>	PROJ0006438
<input checked="" type="checkbox"/>	PROJ0008507
<input type="checkbox"/>	PROJ0008712
<input type="checkbox"/>	PROJ0011073
<input type="checkbox"/>	PROJ0011074

Clicking outside the selection mark will reset the selection

You can export the selection in csv or excel format. Choose the format from the Export Selected dropdown menu

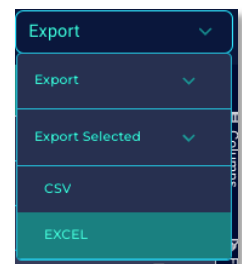

## 2D view

To enable the 2D view, click on the 2D icon

A Bay Plan is displayed. Scroll down to navigate through the bays

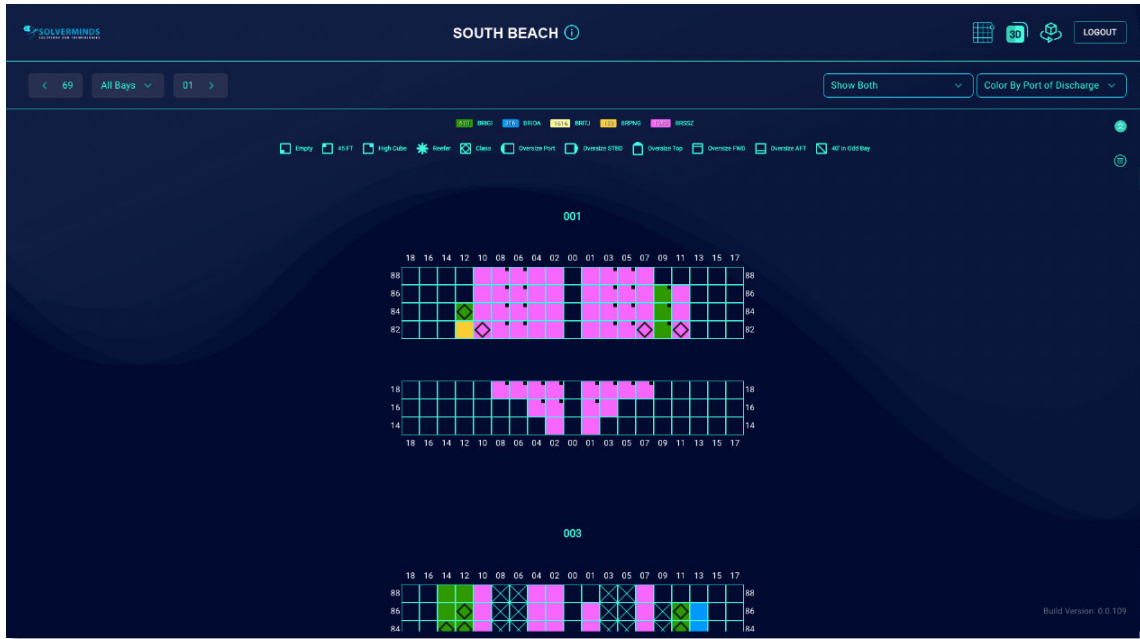

On top of the bay view, there is a high-level RECAP showing the number of units by POD

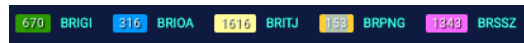

In the bay view, the container type is identified by specific icons. There is a legend on top of the bay view showing the different icons identification



You can enable or disable the legends and the RECAP by using the *Hide Legends* icon located in the upper-right section

An option to see a detailed description of a selected container is available in the upper-right section. Click on the *Show/Hide Description* icon  to enable the detailed view



Hide Description 	
Container No :	PROJ1573925
Container Type :	General
Stowage No :	011186
Port of Discharge :	BRSSZ
Port of Load :	HKHKG
ISO Code :	22G0
Height :	8ft 6.01in
Length :	19ft 10.50in

On the upper-left section, you'll find the navigation panel. Use it to navigate through the bays

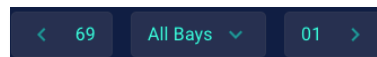

You can use the arrows to navigate to a bay or you can use the dropdown to jump to a specific bay

On the upper-right section, there is a dropdown menu where you can change the view and display upper deck only, lower deck only or both

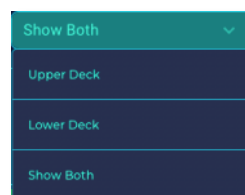

Also, you'll find a tool to color the plan by different attributes. By default, the plan is colored by Port of Discharge

- container type
- ISO code
- Hazardous
- Is OOG
- Reefer
- Length
- Height
- Line Operator
- Port of Discharge

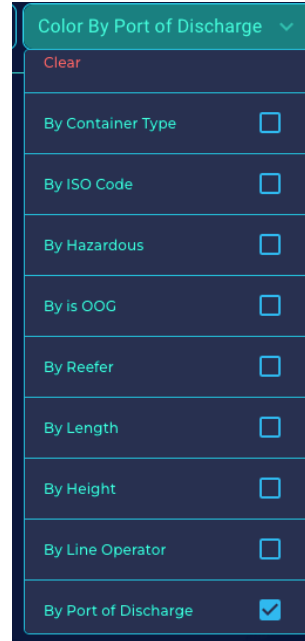

The image shows a dropdown menu titled "Color By Port of Discharge" with a downward arrow. Below the title is a "Clear" button. The menu contains ten options, each with a checkbox:

Attribute	Checked
By Container Type	<input type="checkbox"/>
By ISO Code	<input type="checkbox"/>
By Hazardous	<input type="checkbox"/>
By is OOG	<input type="checkbox"/>
By Reefer	<input type="checkbox"/>
By Length	<input type="checkbox"/>
By Height	<input type="checkbox"/>
By Line Operator	<input type="checkbox"/>
By Port of Discharge	<input checked="" type="checkbox"/>

## 3D View

Switch from 2D to 3D mode by clicking on the 3D icon 

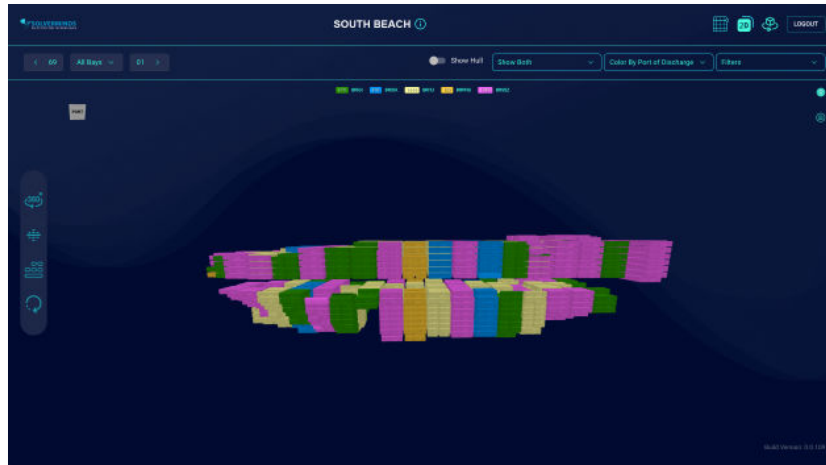

SVM BAPLIE Viewer renders the bay plan into a 3D model showing all the containers on board.

By clicking and dragging you can turn the 3D model around to see different angles.

Using the scroll wheel, you can zoom in or out





## Filter View

When using a filter, the 3D model displays only the filtered container. So if you want to see where a specific type of equipment is stowed, or how are the DG distributed on board, use the filter option

### Filter by reefer

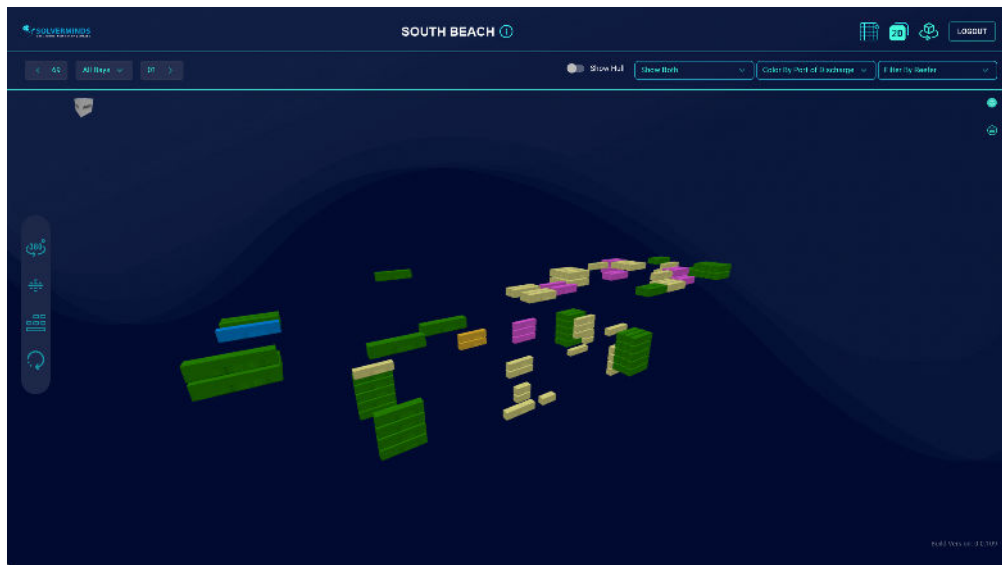

### Filter by DG

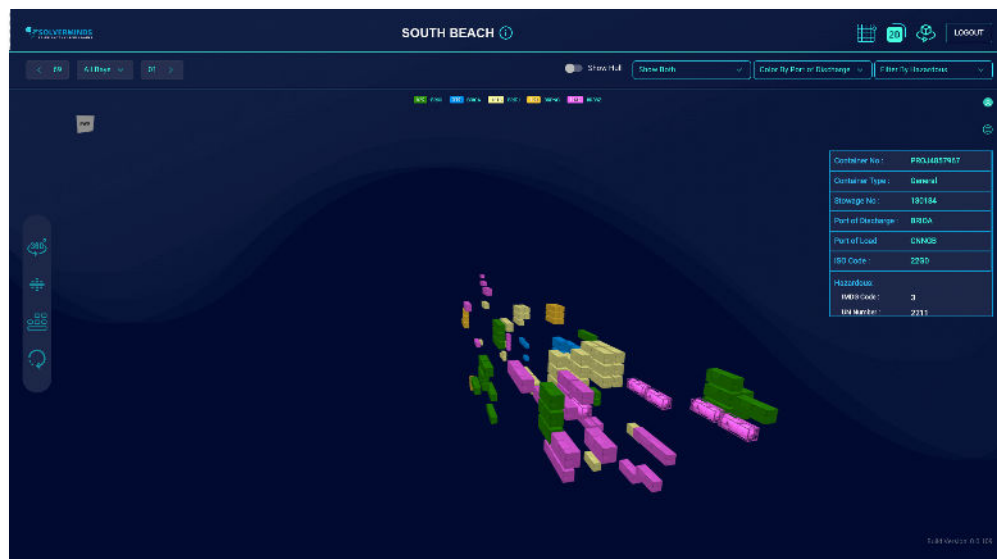

By clicking on a container, you can see the detailed information



## 3D control panel

In the 3D view, there is a toolbar located on the center-left side of the screen.

The toolbar contains the following elements:

Toggle icon 

This icon shows the orientation angle of the vessel profile. It rotates along with the vessel profile and it's a reference for the user.

360° rotation view 

Click on it to keep the vessel structure spinning 360 degrees

Hatch Covers 

Enable/disable the hatch covers view

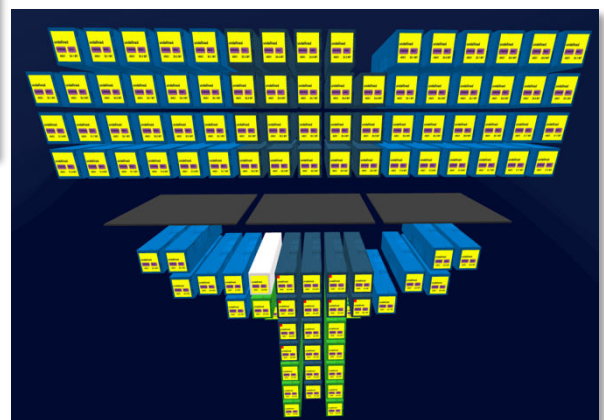
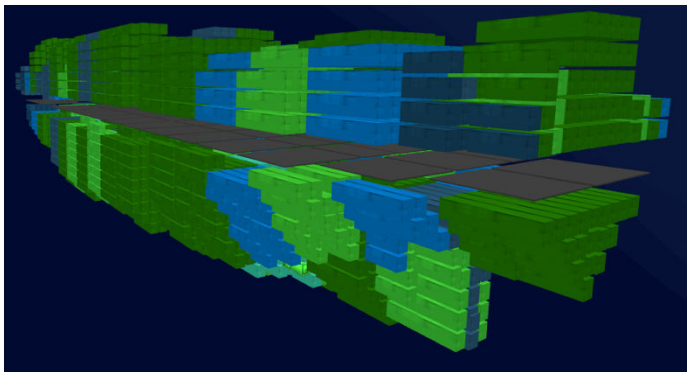

Wire Frames view 

Click on it to turn on the wireframe view when available

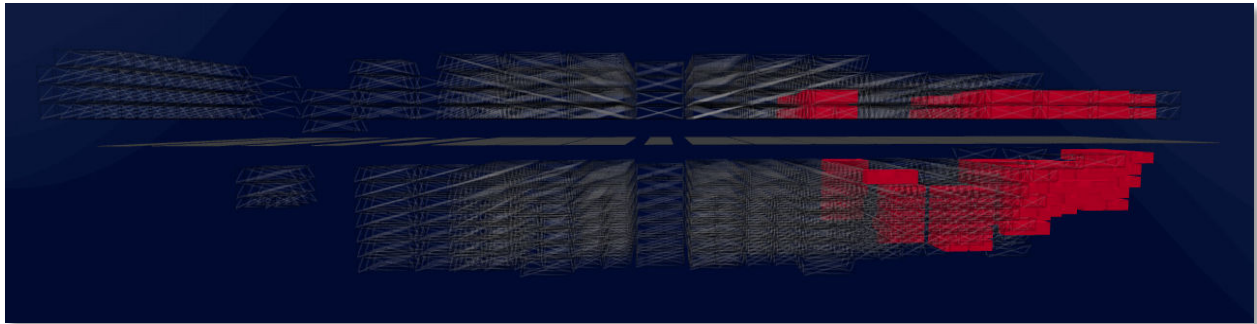

Reset View 

Click on it to reset the vessel view to the initial position

## Hull View

When active, SVM BAPLIE Viewer renders a representation of the vessel's hull based on the bay structure

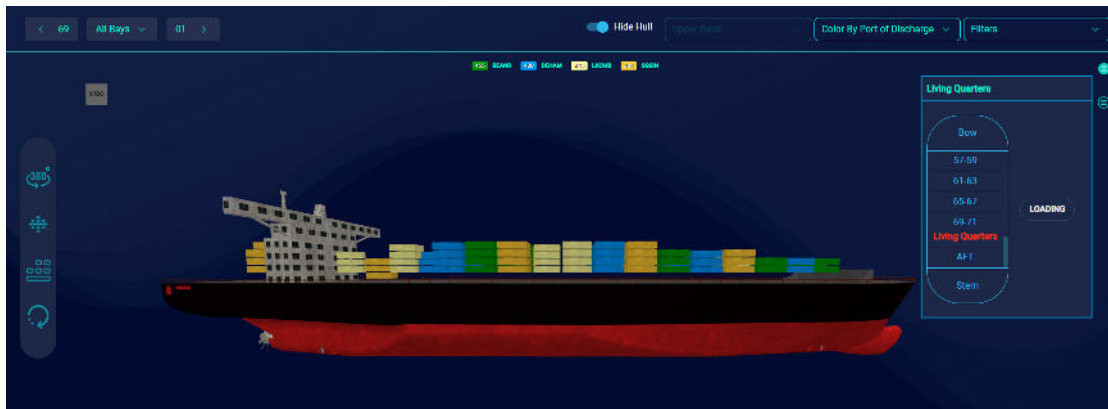

SVM BAPLIE Viewer also renders a representation of the living quarters based on the bay gap. However, for an enhanced representation of the vessel's structure, the user can change the position of the living quarters by clicking on the *Living Quarters* section

Click on the bay in front of the living quarters to assign the new position and click on *SAVE*

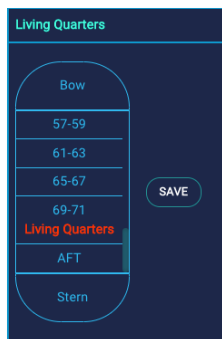

Default position

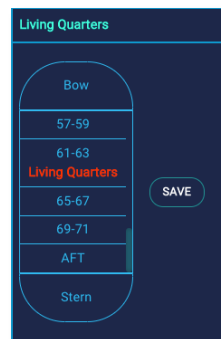

new position